

EQUIPOS INTRAFIX® - PÔSTER DE MANUSEIO

Recomendação para manuseio dos Equipos Intrafix® Primeline e Intrafix® Safeset em **frascos de vidro**

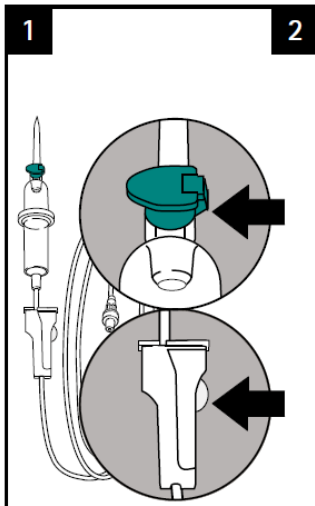

Tire o equipo da embalagem e verifique se o **respiro está fechado** e a **pinça rolete** está aberta

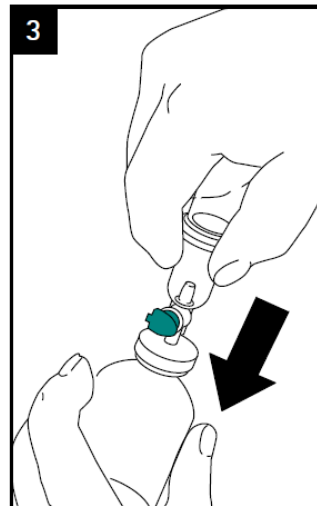

Conecte no frasco de vidro

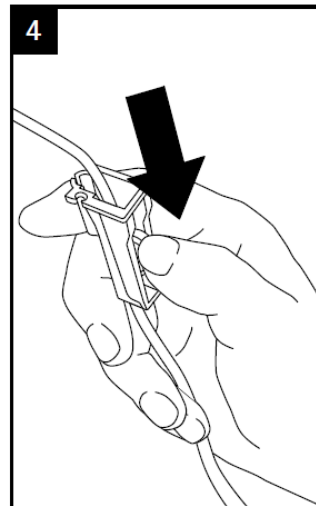

Feche a pinça rolete

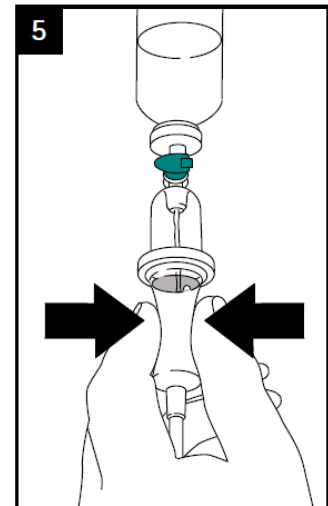

Vire o sistema IV de cabeça para baixo. **Aperte a câmara de gotejamento** preenchendo de fluido até o anel da câmara

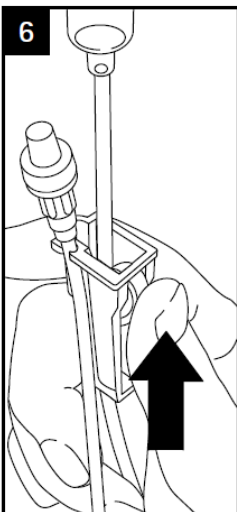

Abra a pinça rolete

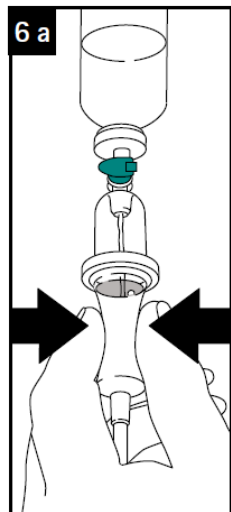

Aperte a câmara de gotejamento outra vez

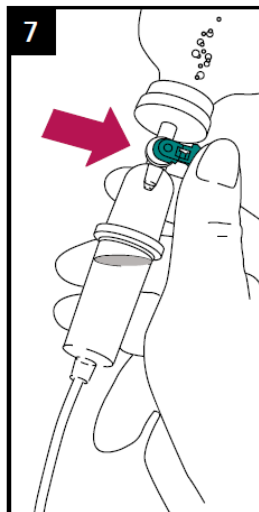

Agora: Abra a tampa do respiro (bolhas de ar vão subir no recipiente)

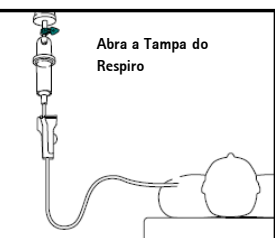
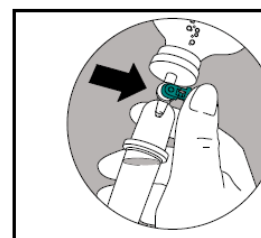
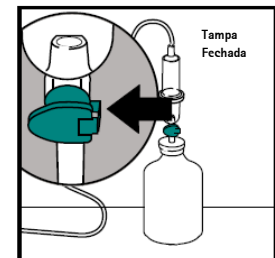
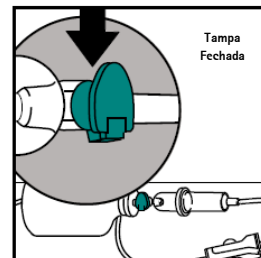

Importante: Quando se prepara uma medicação, normalmente a colocam sobre bancadas e bandejas na posição horizontal – **feche a tampa do respiro antes**. Quando instalar a medicação, **abra novamente para infusão escoar**.

